

\$1,500,000 - 54205 Rge Rd 20, Rural Lac Ste. Anne County

MLS® #E4455982

\$1,500,000

2 Bedroom, 3.00 Bathroom, 2,041 sqft

Rural on 39.20 Acres

None, Rural Lac Ste. Anne County, AB

Welcome to this unique property in Lac Ste Anne County, located only 20 minutes to Stony Plain. This property is 39.2 acres of park-like setting with a shop-house nestled down in the trees. The house is a ranch style 2040 sqft bungalow with no basement built on a 6" concrete slab with in-floor heat. Complete with 2 large bedroom including the primary bedroom with 9' ceilings, a large walk in closet & 4p ensuite with huge shower. The kitchen has quartz counter tops, tons of white cabinets, SS appliances & large island great for entertaining. The front room is open concept with 22' vaulted ceiling, large windows & a wood-burning fireplace. 2 more bathrooms compete the home, one with quick access to the attached 40x60 shop with 16' ceilings (2x14' doors), the concrete for the shop pad is 8" thick & has a floor drain. There are 2 radiant heaters in the shop. Outside are 2 seacans, a large garden shed, raised garden beds & in-ground garden area. There is a wrap a round deck around 3 of the sides of the house.

Built in 2022

Essential Information

MLS® # E4455982

Price \$1,500,000

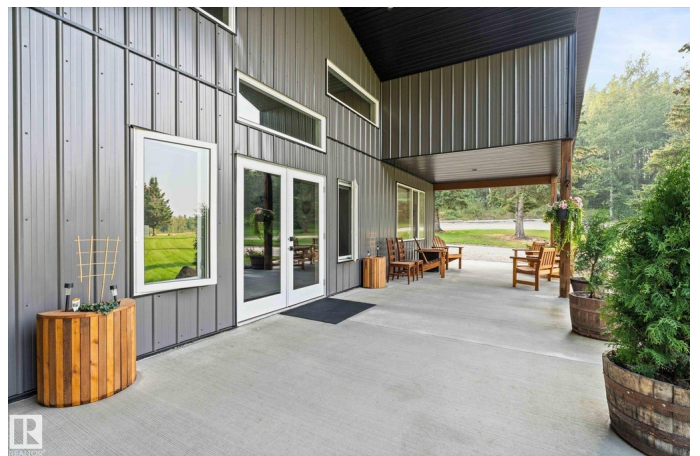

Bedrooms	2
Bathrooms	3.00
Full Baths	3
Square Footage	2,041
Acres	39.20
Year Built	2022
Type	Rural
Sub-Type	Detached Single Family
Style	Bungalow
Status	Active

Community Information

Address	54205 Rge Rd 20
Area	Rural Lac Ste. Anne County
Subdivision	None
City	Rural Lac Ste. Anne County
County	ALBERTA
Province	AB
Postal Code	T0E 1V0

Amenities

Features	Hot Water Instant, Hot Water Natural Gas, Hot Water Tankless, Patio, Vaulted Ceiling, Workshop
----------	--

Interior

Interior Features	ensuite bathroom
Heating	In Floor Heat System, Natural Gas
Fireplace	Yes
Stories	1
Has Basement	Yes
Basement	None, No Basement

Exterior

Exterior	Wood
Exterior Features	Landscaped, Low Maintenance Landscape, Private Setting, Treed Lot, Partially Fenced
Construction	Wood
Foundation	Slab

Additional Information

Date Listed September 4th, 2025

Days on Market 11

Zoning Zone 70

DATA IS DEEMED RELIABLE BUT IS NOT GUARANTEED ACCURATE BY THE REALTORS® ASSOCIATION OF EDMONTON. COPYRIGHT 2025 BY THE REALTORS® ASSOCIATION OF EDMONTON. ALL RIGHTS RESERVED. Trademarks are owned or controlled by the Canadian Real Estate Association (CREA) and identify real estate professionals who are members of CREA (REALTOR®, REALTORS®) and/or the quality of services they provide (MLS®, Multiple Listing Service®)

Listing information last updated on September 15th, 2025 at 12:17pm MDT